

PUMP & BLOWERS

Piston Distributors

DPB and DPF Series



DS 2, 3, 5 and 8 Series



DSA 2, 4, 6 and 8 Series



DSB 3, 5 and 7 Series



Adjustable Feeders

VA Series



VB Series



Grease Distributors

SG23, SG24, SG25 and SG26 Series



SG604, SG606, SG608, SG610 and SG612 Series



PSS, PST and PTT Series



KPF and KPB Series



CSS, CST and CTT Series



Manual Grease Pumps

SHGD61 and
SHGD121 Series



SHGD6 and
SHGD12 Series



Automatic Grease Pumps

MHG71 and
MHG72 Series



MHG41 and
MHG42 Series



WB2 Series



WBR2 Series



Timers

YD Timer



YM Timer



YX Timer



YT Timer



Adapters, Connectors, Swivels, Hoses, and Junctions

DA and DB Style



DA and DB Style



DA and DB Style



Automatic Piston Pumps (PDI Systems)

LCA3 Series



LCA4 Series



LCB1 Series



LCB2 Series



LCB3 Series



LCB4 Series



LCB5 Series



MLA*W & MLB*W Series



MLA015W,03W,03WT
and 05W Series



MLB015W2,015W3,
and 03W2 Series



MLB015W and
MLB03W Series



LAW-6 and LAW-8 Series
(Manual Pump)



Manual Piston Pumps (SLR Systems)

EA-3 Series



EA8 Series



HLA-7R and
HLA7L Series



"A" Series



"FA" Series



"BM" Series



LD6 and LD8 Series



LA3 Series



LA8D Series



Automatic Piston Pumps (SLR Systems)

SMA Series



SMD Series



SSMA Series



YMB Series



YMAS Series



YMAS-36YN



MY6 Series



Pneumatic (Air Operated) Pumps

HP4W Series



HP8W Series



Automatic Gear Pumps (SLR Systems)

MLA, MLC and MLD Series



MLA015-FAH



MV1 and MV3 Series



MLA10,15,30,50,70 and 100 Series



MLD052,102,302,304,503,505,704,705,1004 and 1005 Series



MLA006,015,03,05 and 05-5 Series



MLC051 and MLC101 Series



GRACO Pump

Husky Air operated double diaphragm Pumps

HUSKY 205



HUSKY 307



HUSKY 515



HUSKY 716



HUSKY 1040



HUSKY 1590



HUSKY 2150



HUSKY 3275



Transfer Pumps



Spray Guns



Electrostatic
Air Spray Guns



Accessories



Abrasion Resistant
Pump Series



Husky Corrosion
Resistant



Husky Standard
Pumps



Sanitary
Pump Series



Industrial Relays, Industrial Control Relays, Time Delay Relays

Industrial Control Relays



- Card relays RB104,105
- Relays-and-terminal module
- Miniature control relays HH52, HH53, HH54
- Miniature power relays HH62, HH63, HH64
- General purpose relays HH22, HH23, HH24

Industrial Relays



- Standard type (SH series)

Annunciator Relay Units



- General information
- Ordering code system
- Selection guide
- Super Timers(MS4S series)
- Miniature size super timers (ST7P series)

Time Delay Relays



- General information
- Ordering code system
- Selection guide
- Super Timers(MS4S series)
- Miniature size super timers (ST7P series)

Molded Case Circuit Breakers

Molded Case Circuit Breakers



Distribution breakers F series



Solid-state trip types



Earth Leakage Circuit Breakers

Earth Leakage Circuit Breakers



Circuit Protectors, Low Voltage Fuses

Circuit Protectors



- CP31, CP3*D series
- CP3*F series
- CP3*P series
- CP5*B series
- CP3*E, CP3*V series

Low Voltage Fuses



Multi Display Lights, Rotary Switches, Panel Switches, Terminal Blocks

Command Series



- AR16, AF16 series
- AR22 and DR22 series
- AR30 and DR30 series
- AH164 and AH165, AH165-2 series
- AG22 and AG23
- AM22 and DM22
- AH25
- Command box AHX9
- CCC approved

Multi Display Lights AP30F and AP40F

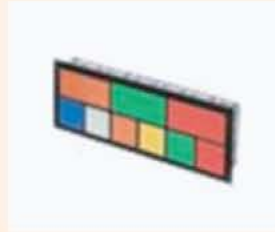

- AP30F
- AP40F

Panel Switches



- Instrument switches RC310 series

Terminal Blocks



- General information
- General purpose terminal blocks (AYBN)
- High quality terminal blocks (AYBS)
- Power terminal blocks (SKT)
- Rail mounted terminal blocks (LT2E)

Magnetic Contactors and Starters, Solid-state Contactors

Standard type Magnetic Contactors and Starters



DC Magnetic Contactors



- SB Series

Definite purpose contactors and starters



- FC Series
- FW Series

Thermal Overload Relays



- Standard type (TR Series)
- With phase loss protective device (TK Series)

Solid-state Contactors



- SS Series

FUJI Electric Low-Pressure Coolant Pump



VKN Series
(flow-rate type)



VKN Series
(pressure type)



VKP Series
(flow-rate type)



VKP Series
(pressure type)



VKV Series

FUJI Electric High-Pressure Coolant Pump



VKA Series
(pressure and flow-rate types)



VKR Series
(pressure type)



VKS Series
(flow-rate type)

Coolant Pump



1. Support of the RoHS Directive environmental load *%substances.
2. Conforms to EU Directives (CE marking).
3. Improved resistance to mist and other environmental elements.
4. Pressure level increased by 30%
5. Compact, lightweight design, integrating motor and pump sections.
6. Self-priming feature for easy installation in confined areas.



1. Support of the RoHS Directive environmental load *%substances.
*Note) Lead, mercury, cadmium, hexavalent, chromium, polybromobiphenyl (PBB), polybromodiphenylether (PBDE)
2. Conforms to EU Directives (CE marking).
3. Improved resistance to mist and other environmental elements.
4. Pump section is immersed in liquid during use.
5. Long and short leg types available to suit various tank depths.
*Products of bottom suction type, those with different voltages, and TV approved series as well as products with short legs or long legs are also available.



1. Support of the RoHS Directive environmental load *%substances.
*Note) Lead, mercury, cadmium, hexavalent, chromium, polybromobiphenyl (PBB), polybromodiphenylether (PBDE)
2. Conforms to EU Directives (CE marking).
3. Improved resistance to mist and other environmental elements.
4. Pressure level increased by 30%
5. Pump section is immersed in liquid during use.

ASK Pressure Gauge

Glycerin pressure gauge Dial size 39 mm. OPG Series



1	Model	Glycerin pressure gauge
2	Profile	Embedded Bar : Square
3	Screw size	R1/4 (PT)
4	Size	39 : ϕ 39mm
5	Pressure range (maximum indication)	1 : 1 MPa 02.5 : 02.5 MPa 04 : 04 MPa 06 : 06 MPa 10 : 10 MPa 16 : 16 MPa 25 : 25 MPa 40 : 16 MPa
6	Stainless steel case	(NEW)

OPG	-	DT	-	R1/4	-	39	x	10MPA	-	S
1		2		3		4		5		6

Glycerin pressure gauge Dial size ϕ 60, ϕ 75, ϕ 100 mm.



1	Model	Glycerin pressure gauge
2	Profile	A type : Frameless B type : Round frame D type : Embedded (with mounting pieces)
3	Stub form	T type : Square U : Two-sided (Model D, only for 75 and 100 mm-diameter type)
4	Screw	G1/4 (only for 60 mm-diameter type) R1/4 (Model A, only for 60 mm-diameter type) G3/8 (75 and 100 mm-diameter types)
5	Dimensions	60 : ϕ 60mm 75 : ϕ 75mm 100 : ϕ 100mm
6	Pressure range (maximum indication)	See the pressure range table

OPG	-	A	T	-	G1/4	-	60	x	10MPA
1		2	3		4		5		6

Glycerin pressure gauge Dial size ϕ 60, ϕ 75, ϕ 100 mm.



1	Model	Glycerin pressure gauge. Made of stainless steel
2	Profile	A : Frameless
3	Stub form	T : Square
4	Screw	G1/4 R1/4
5	Size	60 : ϕ 60mm
6	Maximum Indication	See the Pressure Range Table.

OSG	-	A	T	-	G1/4	-	60	x	10MPA
1		2	3		4		5		6

ASAHI Pressure Gauge

ASAHI GAUGE MFG. CO.,LTD. are manufacture the Pressure Gauge under the name of OSAKA Gauge with wide range of model suit you pressure monitoring application such as General Pressure Gauge, Stainless steel Pressure Gauge, Super-high Pressure Gauge, Low range Pressure Gauge, Differential Pressure Gauge, Small-size Pressure Gauge, Oil-Sealed Pressure Gauge, Digital Pressure Gauge, Pressure Gauge with electric contact, Pressure Transmitter, Pressure Switch.

Pressure Gauge (Range from 0 to 200 MPa.)

Vacuum Gauge (Range from -0.1 to 0 MPa.)

Compound Pressure Gauge (Range from -0.1 to 4 MPa.)



OSAKA Standard Pressure Gauge Model 101

Size	Type of case	Connection screw	Scale range
60	Type A	G1/4	0.05MPa
75	Type B	G3/8	~
100	Type D	G1/2	200MPa
150			Vacuum

Stem Mounting (Type A) 101-A

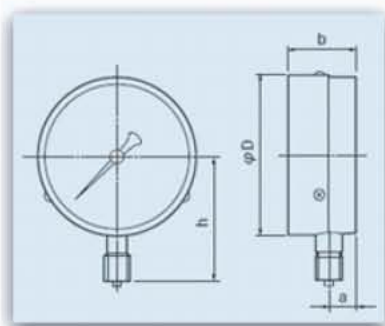

Surface Mounting (Type B) 101-B

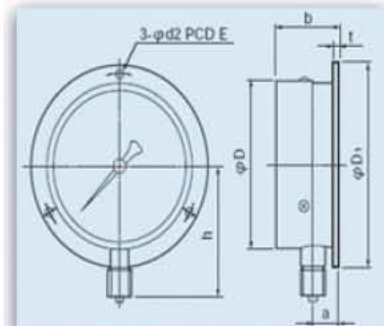

Flush Mounting (Type D) 101-D

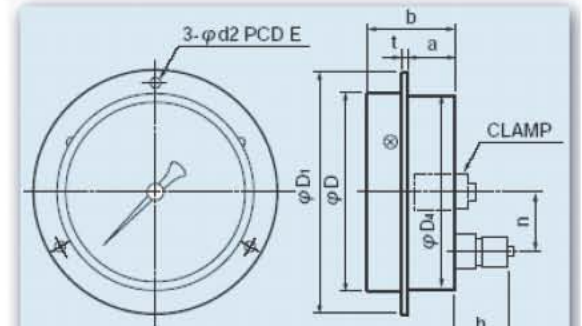

Pump



- SJMS Series
- NX Series
- SLP2 Series
- SVS Series
- LS Series
- MKHS Series
- KSPS Series



- SAM/SPM Series
- SSTM Series
- STM (TU) Series
- SSTM (T) Series
- MSU Series



- M Series
- LS Series
- SJM2 Series
- SJ4 Series
- LP Series



- LG2 Series
- KO Series
- PL Series
- RPU Series
- KCS2 Series
- SVC Series
- BOS Series



- SP3/SP Series
- MSP Series
- MTP Series
- ESPM Series



- NQJ Series
- LFE Series
- LFO Series
- LLS Series
- LSW Series
- NQH Series
- NPJ Series
- LPS Series



- KSP Series
- KH Series



- SVS Series
- SJMS Series



- OKS Series
- GPLII/GPMII Series
- CV Series



- TRP-MHC Series
- TRP-MS Series
- TRP-A Series